



# Pytchley Street

Abington, Northampton

oriordanbond  
SALES & LETTINGS





GROUND FLOOR  
499 sq.ft. (46.4 sq.m.) approx.

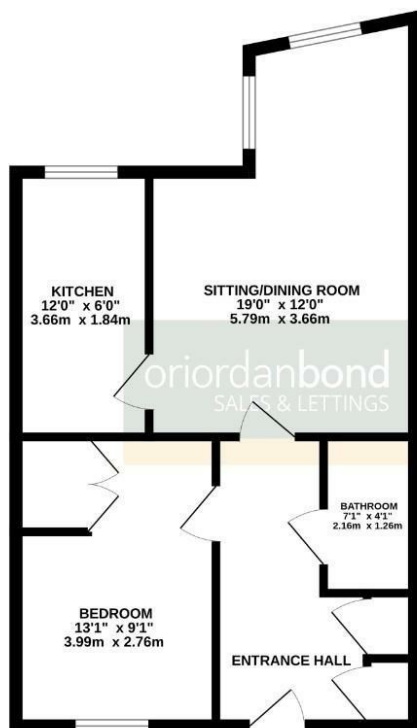

TOTAL FLOOR AREA: 499 sq.ft. (46.4 sq.m.) approx.  
Whilst every attempt has been made to ensure the accuracy of the floorplan contained herein, measurements of doors, windows, rooms and any other items are approximate and no responsibility is taken for any error, omission or misstatement. This plan is for illustrative purposes only and should be used as such by any prospective purchaser. The services, systems and appliances shown have not been tested and no guarantee as to their operability or efficiency can be given.  
Made with NetScout C5025

## Pytchley Street

Abington

NN1 5JD

50% SHARED OWNERSHIP £70,000

A modern ground floor maisonette, offered for sale on a 50% shared ownership basis, situated close to the town centre and Cultural Quarter as well as the general hospital and train station.

The property is ideal as a first time purchase and offers accommodation comprising entrance hall, sitting/dining room open to a fitted kitchen with built-in cooking appliances, double bedroom and three-piece bathroom suite. Benefits include uPVC double glazing, gas radiator heating serviced via a combination boiler and secure allocated parking. (B/499/-)

Leasehold Information: Lease Remaining - 97 years (as of 2026) / Rent on Remaining 50% Share - £152.27 pcm / Service Charge - £150 pcm

### Additional information

- Council Tax Band: A
- Energy Efficiency Rating: C

### Viewing

Viewing strictly by appointment – details below

### Disclaimer

O'Riordan Bond Estate Agents Limited has not tested apparatus, equipment, fittings or services and so cannot verify they are in working order. The buyer is advised to obtain verification from their solicitor or surveyor.

O'Riordan Bond Abington Sales

01604 639007

abington@oriordanbond.co.uk

